

Correct installation of a Eureka Nail-in anchor

The Eureka Nail-in anchor is a push-through fixing because the anchor is pushed through the object and into the mounting surface.

People sometimes confuse a Nail-in anchor with a wall plug and screw. A wall plug and screw is installed in two steps - the wall plug behind the object and the screw from the front of the object. Whereas a Nail-in anchor, in its entirety, is installed in one step from the front of the object.

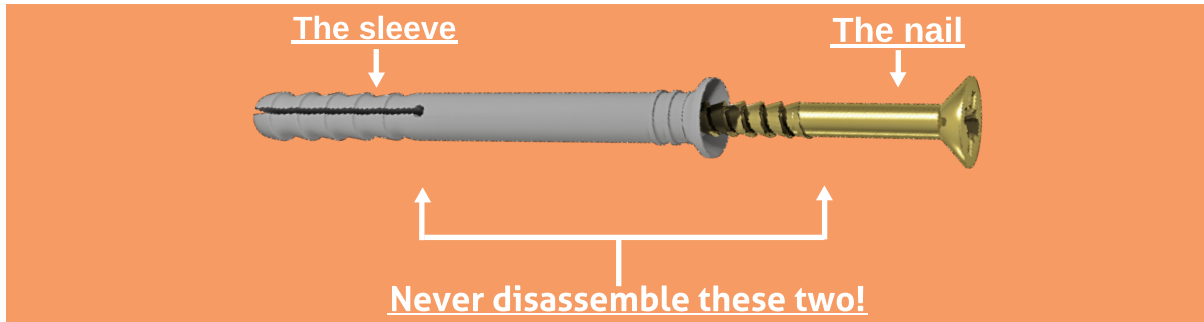

Installation

The Eureka Nail-in anchor should never be disassembled. Incorrect installation can lead to catastrophic consequences such as the object coming off the wall and maybe even falling onto an unsuspecting person below.

An integral part of a Nail-in anchor's installation is the nail's length. For each size Nail-in anchor, the nail is a specific length so that it can expand the sleeve once it's driven in all the way.

And by using a Nail-in anchor incorrectly, you are effectively shortening the nail which then prevents the sleeve from expanding sufficiently, resulting in the anchor not being able to anchor the object to the wall.

Correct installation

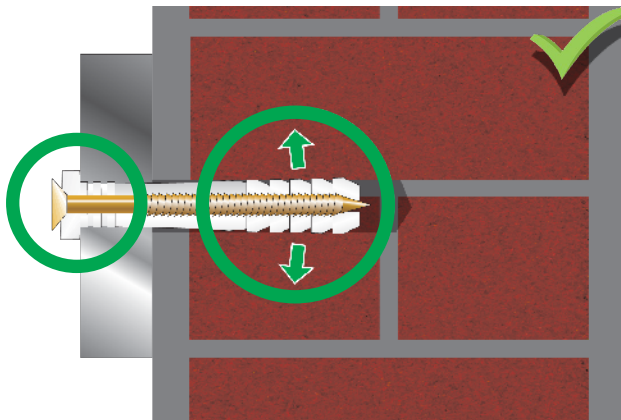

Nail-in anchor expands fully
*Sleeve grips inside of hole
*Object stays on wall

Incorrect installation - FAIL!

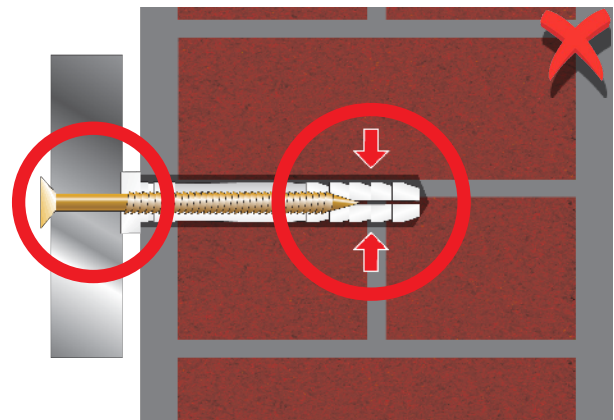

Nail-in anchor does not expand
*Sleeve can't grip inside of hole
*Will pull out - object will fall off wall



Drill the same size hole in the object and in the mounting surface



Place Nail-in anchor through the object and into the mounting surface

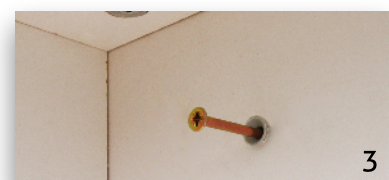

The Nail-in anchor should sit flush against the inside of the object



Knock-in the nail with a hammer

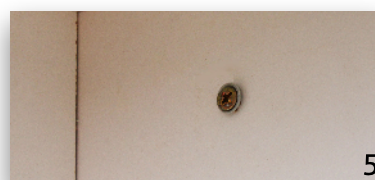

Nail-in anchor is installed once the nail head is flush against the sleeve

EUREKA

FORT KNOX



facebook.com/EurekaDIY/